

## GUARD HOUSE

*Woolwich*

---

Just a stone throw from the River Thames in the heart of the historic Royal Arsenal, we have spaces to suit every wedding reception. Whether you'd like a cosy, intimate gathering in the Mess Bar with the roaring fire, or a lavish celebration in the spacious light-filled Glass House we've got the ideal package for you. We can provide the perfect mix of laid-back style and old fashioned elegance. With three rooms available for private hire, accommodating 15-100 people, we can do small weddings, big weddings, and everything in between.



# CAPACITIES AND FLOOR PLAN

---

*With its large glass doors, the conservatory is bright and light with an added dash of elegance.  
It's the perfect venue for engagement parties and small wedding receptions.*

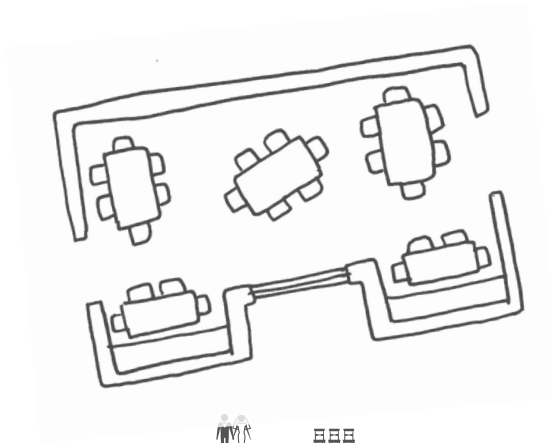
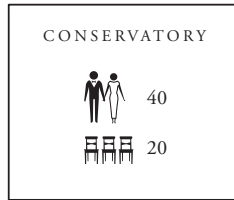

# CAPACITIES AND FLOOR PLAN

*With its own bar, fireplace, large armchairs and quirky decor, the Mess is an exceedingly comfortable and cosy space.*

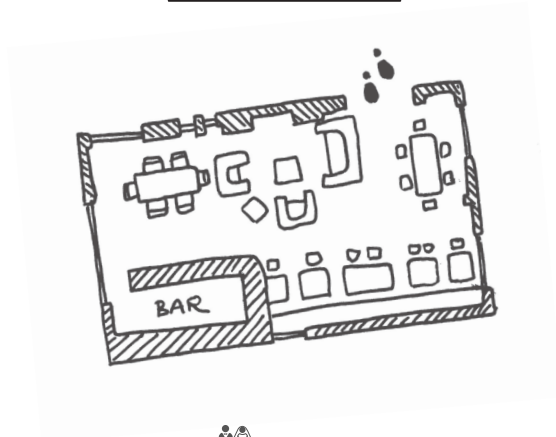

# CAPACITIES AND FLOOR PLAN

*Our most substantial room, the Glass House is a breath-taking space filled with light and colours complementing the magnificent views of the adjacent gardens. The room can easily be tailored to your needs, from a full-on dining room to an extravagant dance floor, and you even have the option of spilling out onto the outside decking area, perfect for those warm summer evenings.*

*The Mess Bar and Conservatory can be joined together to create a larger space.*

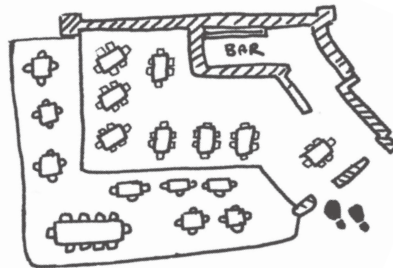
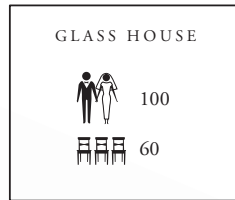



# MENUS

---

## *Set menu 1*

*£30 per person*

Whisky oak smoked salmon, orange, pomegranate and mizuna salad

Confit Gressingham duck leg, smoked bacon, haricot beans, lentils

Pear, fig, honey and cinnamon tart, creme fraiche ice cream

## *Set menu 2*

*£33.50 per person*

Crispy bacon and avocado soldiers with soft boiled duck egg

Lamb shanks with mustard mash and spiced mint sauce

Baked vanilla cheesecake with strawberries

## *Canape Menu*

*£13 per person*

Smoked salmon blinis and beetroot relish

Goat's cheese and black cabbage mini tartlets

Chicken liver parfait with onion marmalade

Miniature pigs in blankets

Herb crusted fish goujons

Cornish Blue and pear tarts with walnut

*seasonal sample menu only*

# ARRIVAL DRINKS

---

Wow your guests with a glass of fizz as they arrive, or perhaps a tailor-made cocktail?

## *Fizz*

Prosecco £5.85 pp

Mimosas £5.85 pp

Kir Royales £8.75 pp

Champagne reception (only available by the bottle. Bottle = 6 glasses)

£8.75 pp

## *Unique cocktail*

A specially designed cocktail for your big day

£5 per cocktail

## *Non-alcoholic*

Elderflower Fizz

£1.95 pp



# WEDDING PACKAGES

---

*Please note that these are examples of packages that we can put together for you.  
Each wedding is specifically tailored, so prices may vary.*

## *Bronze Package*

Prosecco reception, canapes, 2 course set menu, half bottle of house wine,  
tea and coffee station, service charge

*£60 pp*

## *Silver Package*

Prosecco reception, canapes, 3 course set menu, half bottle of house wine,  
tea and coffee station, Prosecco for toasting newlyweds, service charge

*£70 pp*

## *Gold Package*

Champagne reception, canapes, 3 course set menu, half bottle of premium wine,  
tea and coffee station, Prosecco for toasting newlyweds, service charge

*£80pp*

*Whilst we cannot provide a wedding cake, we are happy for you to provide one,  
and we can display and serve it how you wish.*



# OTHER INFO

---

## *Opening times*

Monday - Friday 10am-11pm

Saturday 9am-12am

Sunday 9am-10pm

## *Facilities*

We have disabled access to the rear of the building with toilet with baby changing facilities.

We allow children at all times. Television screens are in every room, with multimedia connections. You are welcome to play your own music from your media device.

## *Getting to The Guard House*

We are sorry to say that the pub does not have parking, however, there is local parking available in Woolwich. We recommend accessing The Guard House via public transport, the nearest DLR station is Woolwich Arsenal. We are within walking distance of Woolwich Town Hall.

# T'S AND C'S

---

## *Securing your booking*

We are delighted to provisionally hold a booking date for you for 10 days; however please be advised should we receive another enquiry during this time we reserve the right to ask you for immediate confirmation in writing, or we may release the date due to popular demand.

## *Deposit and payment terms*

Your booking is only confirmed once we have received your completed signed booking form and 30% of your minimum spend as a deposit.. Please note that the deposit is non refundable.

## *Equipment and extra furniture*

If your event plans require us to hire in any special catering equipment or extra furniture, we will let you know the cost implications to you well in advance.

## *Guest numbers and pre-ordering*

We ask that you confirm final numbers of people attending your event and full food choices at least 10 days before your booking. Should guest numbers decrease with less than 24 hours' notice you will be charged the full menu price. Please notify us at the time of booking if anyone in your party has any dietary requirements.

## *Service charge*

A discretionary 12.5% service charge will be added to your final bill. By the end of your event we are sure you'll agree our staff deserve it, and if not, please do let us know why.

## *Special requests*

May we also remind you that we are here to ensure that you and your guests have a simply fantastic time celebrating with us. So please, do let us know if you have any particular requests no matter how farfetched and we will always do our best for you.

# FIND US

---

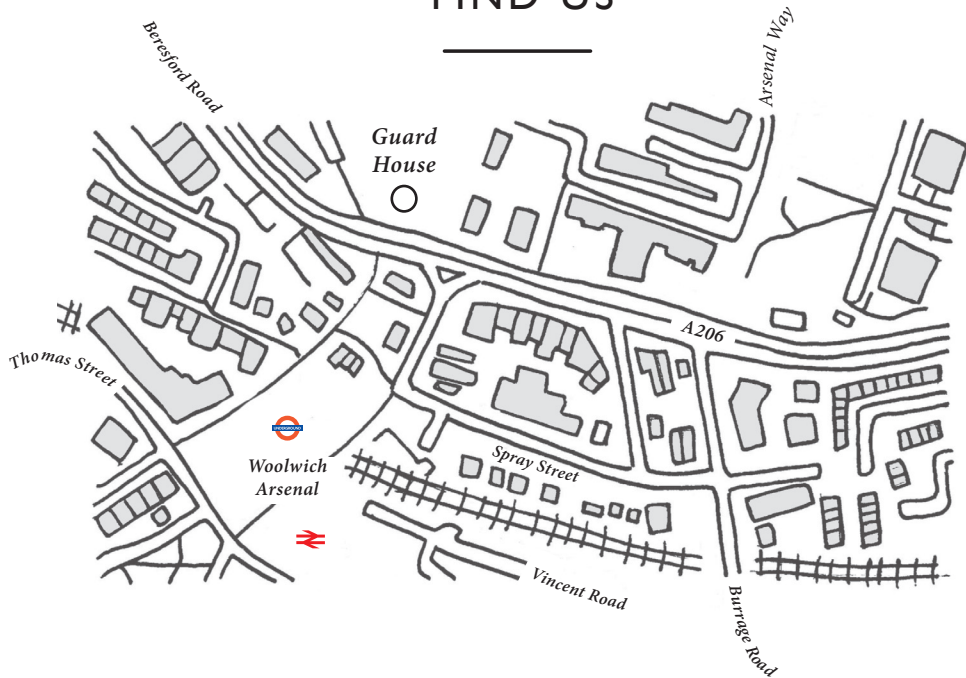

## GUARD HOUSE

*Woolwich*

No 1 Street, Woolwich Arsenal, London SE18 6GH

[theguardhouseevents@geronimo-inns.co.uk](mailto:theguardhouseevents@geronimo-inns.co.uk)

0203 437 0900

[www.theguardhousewoolwich.co.uk](http://www.theguardhousewoolwich.co.uk)

📍 [theguardhouse](#)